

# TRIKY

## Electric pallet truck for external use

Load capacity kg 1.200



It can travel on dirt or grass floors



Asphalt, gravel, tiles, squares...  
no problem!

### TECHNICAL FEATURES

Load capacity 1,2t

Sealed batteries up to 120Ah

Rain protection (IPx3)

1,2kw AC powder drive motor with kinetic energy recovery system.

Large diameter Superelastic rubber wheels

FEM forks

Silent running < 61dBA at the operator's ear

### FOCUS ON ITS ADVANTAGES

Now you can **transport loads on asphalt, gravel, clay yards**: TRIKY always guarantees traction and power in every situation.

The **superelastic rubber wheels** of large diameter and the remarkable light on the ground of the frame **allow you to pass on uneven pavement** and to overcome even very inclined ramps.

TRIKY has been studied in every detail to ensure **maximum silence** for night work (< 61dBA to the operator's ear \*).

The traction motor is **powerful** and the AC technology allows the pallet truck to maintain a **constant speed even during a descent**.

The sturdiness of the frame and the study of ergonomics allow TRIKY to be enjoyed in **complete safety**.

### Standard equipment

24V 90Ah sealed batteries

HF charger

Rain protection (IPx3)

On-board diagnostic

Battery status indicator

FEM forks

Sculpted rubber wheels

### Main optional features

120Ah sealed batteries

Load backrest

# Technical data

Features	1.1	Manufacturer		Logimach	Logimach
	1.2	Model		TRIKY	TRIKY LW
	1.3	Drive		Electric	Electric
	1.4	Operator type: pedestrian, stand-on		Pedestrian	Pedestrian
	1.5	Rated load capacity	Q (t)	1,2	1,2
	1.6	Load centre	c (mm)	600	600
	1.9	Wheelbase	y (mm)	1.301	1.301
Weights	2.1	Truck weight incl. Battery (see line 6.5)	kg	364	...
	2.2	Axle loading, laden, drive end/load end.	kg	1.157/407	...
	2.3	Axle loading, unladen, drive end/load end	kg	155/209	...
Rollers & Weels	3.1	Tyres, Drive end / Load end (G = Rubber)		G/G	G/G
	3.2	Wheel size, drive end	mm	300x85	300x85
	3.3	Wheel size, load end	mm	398x94	398x94
	3.5	Number of wheels drive end/load end (x = powered)		x1/2	x1/2
Basic dimensions	4.4	Lift	h3 (mm)	247	247
	4.9	Height of tiller in driving position min/max	h14 (mm)	989/1.295	989/1.295
	4.15	Ground clearance, forks lowered	h13 (mm)	40	40
	4.19	Overall length	l1 (mm)	1.977	1.977
	4.20	Length incl. Fork backs	l2 (mm)	776	776
	4.21	Overall width	b1 (mm)	1.057	1.057
		Overall width, load end	(mm)	1.150	1.150
	4.22	Fork dimensions	s/e/l (mm)	30/80/1.200	30/80/1.200
	4.25	Overall fork width	b5 (mm)	540	...
		Clearance, forks raised	(mm)	100	100
	4.34	Working aisle width with 800x1200 pallet lengthways	Ast (mm)	2.398	2.587
4.35	Turning radius	Wa (mm)	1.609	1.610	
Performance	5.1	Travel speed laden/unladen	km/h	5,5/5,5	5,5/5,5
	5.2	Hoist speed laden/unladen	m/s	0,03/0,04	0,03/0,04
	5.3	Lowering speed laden/unladen	m/s	0,07/0,03	0,07/0,03
	5.8	Max. gradeability laden/unladen	%	5/15	5/15
	5.10	Service bracke		Electromagnetic	Electromagnetic
Electric	6.1	Drive motor, rating at S2 = 60min	kW	1,2	1,2
	6.2	Hoist motor, rating at S3 = 10%	kW	0,8	0,8
	6.4	Battery voltage, rated capacity K5	V/Ah	120Ah	120Ah
	6.5	Battery weight	kg	85	85
Other	8.1	Electric drive control		AC Technology	AC Technology
	8.4	Sound level at driver's ear (ref. EN 12053)	dB (A)	< 70	< 70

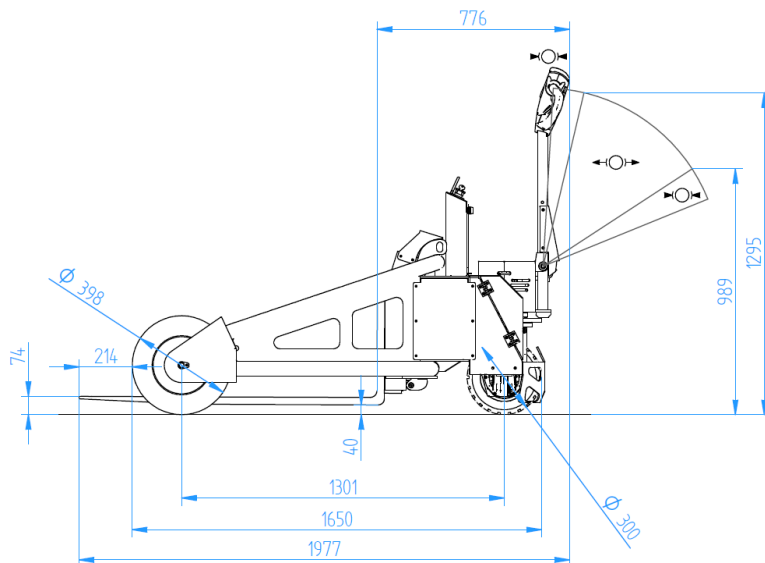
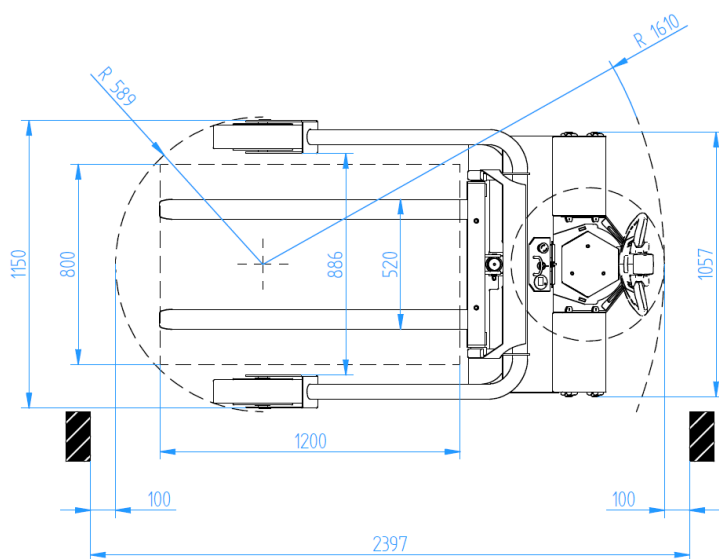

Technical data sheet according to VDI 2198

\* Sound level measurements carried out comply with the strict Italian legislation on health and safety in the workplace with regard to exposure to the physical agent noise

Some images in this brochure may show non-standard features. The accuracy of this brochure has been checked before printing. Since we at Carrellificio Cesenate strive to continuously improve our products, we reserve the right of changing the design, technical features, prices, and colours of these items any time

**CARRELLIFICIO CESENATE di Minotti Marco & C. SNC**

Via Cerchia di Sant'Egidio, 850 – 47521 Cesena (FC) - Italy  
Tel +39 0547 381150 – Fax + 39 0547 631202  
info@logimach.com www.logimach.com

Dealer